

Residential Sliding Gear

PC Henderson has long been acknowledged as the world leader in the design and manufacture of quality Sliding Gear Systems. The comprehensive range of systems shown here are suitable for cabinets, cupboards, wardrobes, interior doors and room dividers in residential premises, apartments, hotels, schools and offices.

The main advantage of using a sliding door is that it saves room space as the door does not require a swing space to open. Using sliding doors is therefore a practical and fashionable option where space is at a premium. Sliding doors also offer a touch of individuality to a room design.

Henderson systems are designed and engineered with particular attention to aesthetic appearance, smooth and silent operation and ease of installation.



Slipper *the cupboard twin slide*

- ▶ for fitted furniture of all kinds eg kitchens, bathrooms, serving hatches of lightweight wood or chipboard
- ▶ quiet nylon slides on attractive aluminium track
- ▶ easily top fixed
- ▶ simple to remove doors for cleaning and decorating

specification

max door weight		9kg
max door width		900mm
door thickness		16-30mm
kit	opening width	no. doors
SS4	max 1200mm	■ — ■
SS5	max 1500mm	■ — ■
SS6	max 1800mm	■ — ■

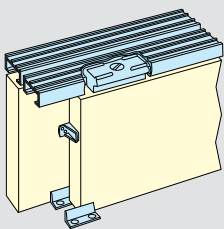

Zenith *the glass cabinet slide*

- ▶ for showcases, bookcases, display panels, hatches, interior windows and glass doors
- ▶ a precision made, satin-anodised finish aluminium gear with brush-pile strips
- ▶ silent and easy to glide

specification

max door weight		25kg
max door width		900mm
door thickness		6mm
kit	opening width	no. doors
Z12	max 1200mm	■ — ■
Z15	max 1500mm	■ — ■
Z18	max 1800mm	■ — ■

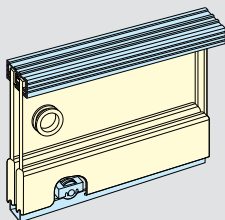

Loretto *the cupboard twin slide*

- ▶ for cupboards, bookcases and other good quality cabinet work
- ▶ for timber framed, glazed or flush doors
- ▶ quiet and smooth - nylon guides and rollers, with aluminium rail

specification

max door weight	23kg	
max door width	900mm	
door thickness	20-45mm	
kit	opening width	no. doors
D4	max 1200mm	■ — ■
D5	max 1500mm	■ — ■
D6	max 1800mm	■ — ■

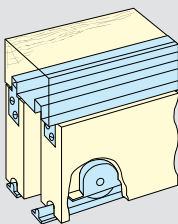

Cello *the wardrobe/cupboard twin slide*

- ▶ for cupboards and wardrobes
- ▶ for timber, timber framed or composite doors
- ▶ quiet and smooth - nylon guides and rollers, with aluminium rail



specification

max door weight	25kg	
max door width	920mm	
door thickness	40mm	
kit	opening width	no. doors
C15	max 1500mm	■ — ■
C18	max 1800mm	■ — ■
C24	max 2400mm	■ — ■

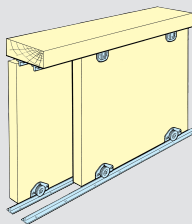

Senator *the entry door slide*

- ▶ for entrance doors and doors between rooms
- ▶ for timber, timber framed or composite doors
- ▶ silent - nylon guides and hangers on aluminium track
- ▶ floor component - guide only

specification

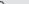
max door weight	30kg	
max door width	900mm	
door thickness	20-35mm	
kit	opening width	no. doors
SEN	max 900mm	

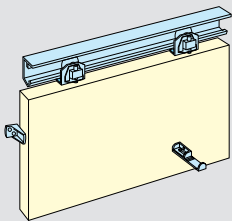

Phantom *the silent slide*

- ▶ for room dividers - for domestic, hospital and hotel use
- ▶ for timber, timber framed or composite doors
- ▶ ultra silent, frictionless, easy operation
- ▶ floor component - guide only
- ▶ simultaneous action option

specification

max door weight	45kg	
max door width	610-915mm	
door thickness	30-50mm	
kit	opening width	no. doors
P9	610-915mm	

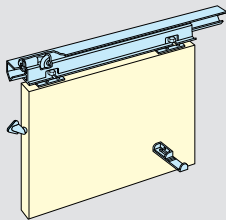

Single Top *the wardrobe slide*

- ▶ for timber framed or composite doors
- ▶ silent - nylon hangers and aluminium track
- ▶ easily adjusted door height
- ▶ floor component - guide only

specification

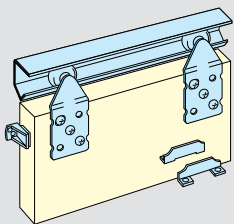

max door weight		45kg
max door width		900mm
door thickness		16-40mm
kit	opening width	no. doors
ST12	max 600mm	
ST15	max 750mm	
ST18	max 900mm	



Husky 50 *the wardrobe and room divider slide*

- ▶ for timber, timber framed, composite or metal doors
- ▶ for medium weight doors
- ▶ quiet operation - galvanised steel track with nylon rollers
- ▶ floor component - guide only

specification

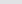
max door weight	50kg	
max door width	1250mm	
door thickness	20-50mm	
kit	opening width	no. doors
H50/15	max 800mm	
H50/18	max 950mm	
H50/20	max 1050mm	
H50/24	max 1250mm	

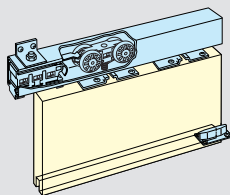

Two kits required

SIM 100 *simultaneous action kit*



specification

simultaneous action kit	SIM100x1
max door weight	100kg
door thickness	20-50mm
max door width	1250mm

- ▶ Designed to be used in conjunction with a pair of Husky 50, Husky 100 or Pocket Door Kits
- ▶ For internal partition bi-parting timber doors
- ▶ This kit can be retro fitted to existing installations
- ▶ Ideal for pairs of doors opening in to cavity walls
- ▶ For use with either steel or aluminium Husky track
- ▶ Polypropylene coated cable for quiet operation
- ▶ Spring tension providing smooth operation
- ▶ Pulley wheels complete with bearings to provide reliable operation

Pocket Door *cavity wall system*

- ▶ Residential interior doors that need to slide into a wall cavity.
- ▶ Ideally suited to applications where space is at a premium such as toilets, bathrooms and kitchens.
- ▶ All sets come complete with pre-assembled aluminium track and header assembly.
- ▶ The Pocket Door uses the Husky sliding door gear system with aluminium track and fully adjustable floor guide.
- ▶ Overall wall thickness with 12.5mm wall boards is 115mm.

specification

For individual doors:

max door weight	60kg
door thickness	28-44mm

door sizes:



PDK3 up to	1981mm high x 762mm wide
PDK4 up to	1981mm high x 838mm wide
PDK5 up to	2040mm high x 762mm wide
PDK6 up to	2040mm high x 826mm wide
PDK7 up to	2040mm high x 726mm wide
PDK10 up to	2315mm high x 930mm wide



Marathon 55 *the heavy duty slide*

- ▶ used for heavy-duty domestic and light commercial applications, doors and partitions
- ▶ for timber, timber framed or composite doors
- ▶ easily adjusted door height
- ▶ can be used externally if gear is adequately protected against the weather
- ▶ simultaneous action option

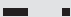
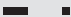
specification

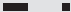
max door weight	55kg	
max door width	1500mm	
door thickness	32-50mm	
kit	opening width	no. doors
J2	400-750mm	
J3	750-900mm	
J4	900-1050mm	
J5	1050-1200mm	
J6	1200-1500mm	

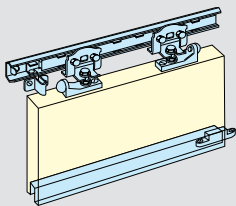

Marathon 90 *the heavy duty slide*

- ▶ used for heavy-duty domestic and light commercial applications, doors and partitions
- ▶ for timber, timber framed or composite doors
- ▶ easily adjusted door height
- ▶ can be used externally if gear is adequately protected against the weather
- ▶ simultaneous action option
- ▶ fire door kit option available



Two kits required

specification

max door weight	90kg	
max door width	1500mm	
door thickness	32-50mm	
kit	opening width	no. doors
S3	750-900mm	
S4	900-1050mm	
S5	1050-1200mm	
S6	1200-1500mm	

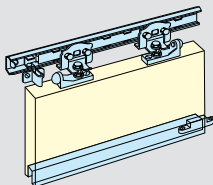

Double Top *the wardrobe/cupboard twin slide*

- ▶ for heavy duty applications - wardrobe, cupboards, in hotels, schools, hospitals and offices
- ▶ for timber, timber framed or composite doors
- ▶ silent - nylon hangers and aluminium track
- ▶ easily adjusted door height
- ▶ floor component - guide with channel as non-standard option

specification

max door weight		45kg
max door width		900mm
door thickness		16-40mm
kit	opening width	no. doors
W12	max 1200mm	■ — ■
W15	max 1500mm	■ — ■
W18	max 1800mm	■ — ■
W24	max 2400mm	■ — ■

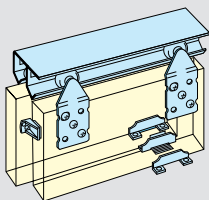

Bifold *the folding cupboard slide*

- ▶ for timber, timber framed or composite doors
- ▶ stable and smooth running
- ▶ suitable for jambless openings
- ▶ silent and easy to fix - nylon spring-loaded guides with attractive aluminium top track
- ▶ leaves to fold back completely



specification

max leaf weight	14kg	
max leaf width	530mm	
leaf thickness	20-35mm	
kit	opening width	no. leaves
B10	max 1065mm	■ ^
B15	max 1525mm	■ ^ ^ ■
B20	max 2135mm	■ ^ ^ ■

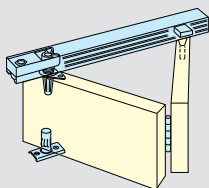

Commercial & Industrial Ranges

Henderson sliding and folding hardware is incredibly diverse ranging from lightweight to 8000Kg and up to 20m in height. Henderson products are very versatile and can be used in a multitude of applications, moving everything from wardrobe doors, glass panels, timber doors, warehouse doors, shop fronts and gates from one position to another. The hardware can also be used in many non-door applications such as fall arrest systems or for sliding machinery, industrial curtains, sports equipment, projector screens and blackboards.



For full details on either Domestic, Industrial or Commercial systems please contact your local distributor for the relevant literature or contact us direct at **www.pchenderson.com**

P C Henderson Limited

Durham Road, Bowburn,
County Durham DH6 5NG, UK
Website: www.pchenderson.com

Technical Sales Team

Telephone 0191 377 7345
Facsimile 0191 377 3116
e-mail: sales@pchenderson.com

Export Department

Telephone +44 (0) 191 377 7346
Facsimile +44 (0) 191 377 0755
e-mail: international@pchenderson.com

P C Henderson (Ireland) Limited

West Link Industrial Estate,
Kylemore Road,
Dublin 10, Ireland
Telephone +353 (0) 1 626 0444
Facsimile +353 (0) 1 626 0455
e-mail: sales@pchenderson.ie

Securefold

Securefold is the ultimate in exterior folding systems and opens up building design to a wealth of new possibilities. The Henderson Securefold System has been designed to maximise the flexibility of a room's living space, removing barriers and enabling the user to have an indoor/outdoor experience by fully opening up exterior walls. The system which operates with effortless ease combines the benefits of folding doors with uncompromising **security, protection** from the weather, and the **durability** of stainless steel. This modern, contemporary feature will increase available living space whilst allowing natural light to envelope a room.

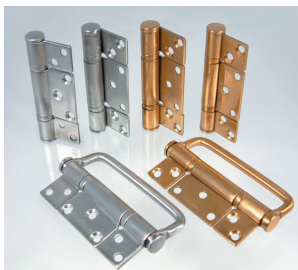

Choosing your Henderson Domestic Gear in ten easy steps

1 Determine application. Wardrobe, Cupboard, Cabinet, Room Divider.

2 Choose Sliding Doors (single doors) or **Folding Doors** (joined pair of doors).

3 Choose fixing method. Face Fixed (onto side of wall) or Soffit Fixed (into lintel or wall cavity).

See drawing below for details.

4 Measure width of opening and determine track length.

Face Fixed = width of opening x 2 (to allow for door parking space).

Soffit Fixed = width of opening.

= width of opening x 2 (for cavity sliding doors).

5 Choose the doors and note material of door

6 Measure width and thickness of each door.

Face Fixed note that the total width of all the doors should be slightly wider than the opening to prevent any gaps.

Soffit Fixed note that the total width of all the doors must be exactly equal to the width of the opening to allow proper closing.

7 Identify how many doors you need.

8 Identify the weight of each single door.

9 Choose correct Henderson Domestic gear and kit number.

Use the table and your information from questions 1-8.

10 Fix your doors.

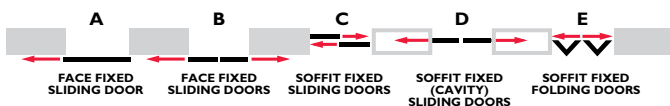

Sliding doors can be Face Fixed with single line of track which allows access to the full width of the opening - but you need wall space where the door(s) can park (A,B). Soffit Fixed with 2 lines of track which allows doors to by-pass each other, giving a partial opening (C). Soffit Fixed with single line of track for cavity installations (D).

Folding doors are normally Soffit Fixed where there is no wall space for the doors to slide to (E).

Pelmets. We recommend that you fix a pelmet the length of the track to cover the track and hangers when installed and to give a pleasing appearance to your sliding doors.

Note: If the door weight exceeds the Domestic Gear choice, you need Henderson Industrial gear shown on our website www.pchenderson.com. To double check your choice of gear against application, please read the descriptions on the next pages.



NAME	DOOR TYPES					FIXING	
	SLIDING			FOLDING		SOFFIT	FACE
	WARDROBE & CUPBOARD (WOOD)	CUPBOARD (GLASS)	ROOM DIVIDER (WOOD)	WARDROBE & CUPBOARD (WOOD)	ROOM DIVIDER (WOOD)		
SLIPPER	●					●	
ZENITH		●				BOTTOM ROLLER (see note 3)	
LORETTO	●						
CELLO	●						
SENATOR			●			●	●
PHANTOM			●			●	●
DOUBLE TOP	●					●	
SINGLE TOP	●					●	●
HUSKY 50	●		●			●	●
MARATHON 55			●			●	●
MARATHON 90			●			●	●
HUSKY 100	●		●			●	●
BIFOLD				●		●	
HUSKY FOLDING 25				●	●	●	
HUSKY FOLDING 40				●	●	●	
SIM 100			●			●	●
POCKET DOOR			●			●	

Notes:

- (1) To give 2 or more Face Fixed Sliding Doors, buy 2 or more 'One Door' kits and join track lengths.
- (2) For Soffit Fixed Sliding Doors - kits that hang 2 doors have a double track.
- (3) Zenith, Loretto and Cello run on bottom rail.
- (4) If longer track length is required please consult your Henderson Stockist.

MAXIMUM DOOR WEIGHT	TRACK LENGTH mm (GEAR KIT No.) See Notes below	MAXIMUM DOOR THICKNESS mm	NUMBER OF SINGLE DOORS EACH KIT WILL HANG	NUMBER OF DOORS (PAIRS) EACH KIT WILL HANG
9 Kg	1200 (SS4) 1500 (SS5) 1800 (SS6)	30	2	
25 Kg	1200 (Z12) 1500 (Z15) 1800 (Z18)	6	2	
23 Kg	1200 (D4) 1500 (D5) 1800 (D6)	45	2	
25 Kg	1500 (C15) 1800 (C18) 2400 (C24)	40	2 or 3	
30 Kg	1500 (SEN)	35	1	
45 Kg	1525 (P9)	50	1	
45 Kg	1200 (W12) 1500 (W15) 1800 (W18) 2400 (W24)	40	2 or 3	
45 Kg	1200 (ST12) 1500 (ST15) 1800 (ST18)	40	1	
50 Kg	1500 (H15) 1800 (H18) 2000 (H20) 2400 (H24)	50	1	
55 Kg	1219 (J2) 1473 (J3) 1702 (J4) 1981 (J5) 2438 (J6)	50	1	
90 Kg	1473 (S3) 1702 (S4) 1981 (S5) 2438 (S6) 3048 (S7) 3226 (S8)	50	1	
100 Kg	1500 (H100/15) 1800 (H100/18) 2000 (H100/20) 2400 (H100/24)	50	1	
14 Kg	1000 (B10/2) 1500 (B15/4) 2000 (B20/4)	35		2(1) 4(2)
25 Kg	1200 (HF25/12) 2400 (HF25/24)	40		2(1) 4(2)
40 Kg	1500 (HF40/15) 3000 (HF40/30)	40		2(1) 4(2)
100 Kg	(SIM 100)	50	2	
60 Kg	1449 (PDK3) 1601 (PDK4) 1601 (PDK5) 1577 (PDK6) 1377 (PDK7) 1785 (PDK10)	44	1	

If you have any queries contact Henderson's Technical Sales Team
Tel: 0191 377 7345 - Fax: 0191 377 3116 - e-mail: technical@pchenderson.com

P C Henderson Ltd. reserves the right to introduce improvements to design and changes to specifications without notice. This is not a controlled document.

Husky Folding 25 *the folding wardrobe slide*

- ▶ for timber, timber framed or composite doors
- ▶ for light residential folding partitions
- ▶ neatly stacking at one or both sides
- ▶ concealed fixing
- ▶ floor component - pivot only

specification

max leaf weight	25kg
max leaf width	600mm
leaf thickness	20-40mm
kit	opening width no. leaves
HF25/12	max 1200mm ■ ▲
HF25/24	max 2400mm ■ ▲▲

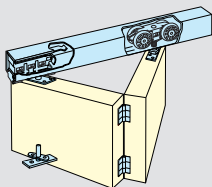

Additional pivots required

Husky Folding 40 *the folding room divider*

- ▶ for timber, timber framed or composite doors
- ▶ for medium weight residential folding partitions
- ▶ neatly stacking at one or both sides
- ▶ concealed fixing
- ▶ floor components - channel and pivots



Additional pivots required

specification

max leaf weight	40kg
max leaf width	750mm
leaf thickness	20-40mm
kit	opening width no. leaves
HF40/15	max 1500mm ■ ▲
HF40/30	max 3000mm ■ ▲▲

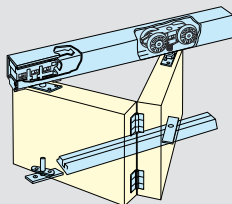

Husky 100 *the room divider slide*

- ▶ for heavy weight room dividers
- ▶ for timber, timber framed, composite or metal doors
- ▶ easily adjustable door height
- ▶ end clip stop to hold door in open position
- ▶ floor component - guide with channel as non-standard option

specification

max door weight	100kg
max door width	1250mm
door thickness	20-50mm
kit	opening width no. doors
H100/15	max 800mm 
H100/18	max 950mm 
H100/20	max 1050mm 
H100/24	max 1250mm 

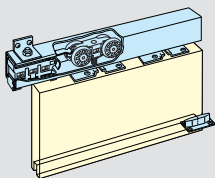

Two kits required

Fascia *domestic clip-on aluminium fascia*



- ▶ for use with Single Top, Double Top, Husky 50 & Husky 100 kits
- ▶ easy to install clip-on fascia
- ▶ made from anodised aluminium

specification

	door thickness
Single/Double Top	F134 16-30mm
	F138 16-18mm
Husky 50/100	F134 20-50mm
	F138 20-25mm
	F140 20-50mm

kit	opening width
F134/15	max 800mm
F134/18	max 950mm
F134/20	max 1050mm
F134/24	max 1250mm
F138/15	max 800mm
F138/18	max 950mm
F138/20	max 1050mm
F138/24	max 1250mm

F140/18	max 900mm
F140/20	max 1000mm
F140/30	max 1500mm
F140/40	max 2000mm
F140/60	max 3000mm

F138



F134

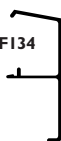

F140

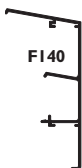

May 2010



Residential Sliding Gear

Design in Motion

HENDERSON